

Floor Type Vacuum Drying Oven

Large Capacity Vacuum Drying Oven

DP43C/63C

Operating temp. range 40~200°C

Operating pressure range 101~0.1kPa

Internal capacity 91L(DP43C) 216L(DP63C)

Large capacity multi-purpose vacuum oven



91L
DP43C

216L
DP63C

Operation and functions

- Interactive key input of the control panel for easy operation
- Equipped with high precision functions such as fixed temperature, quick auto stop, auto stop, auto start and program operations for enhanced performance
- Vacuum reaching time significantly reduced by improvement of the exhaust system, resulting in more efficient operation
- Vacuum pump can be stored in the bottom cabinet, which is suitable for space limited laboratories
- Easy removal of piping and maintenance of vacuum pump
- Calibration off-set function

Safety features

- Enhanced safety features: sensor trouble detection, SSR short circuit detection, heater disconnection detector(sensor), memory error, internal communication error, overheating and measurement temperature error
- Large observation window with protective cover for increased safety

Specifications

Model	DP43C	DP63C
System	Vacuum drying by decompressed chamber direct heating	
Operating temp. range	40°C to 200°C	
Operating pressure range	101 to 0.1 kPa (760 to 1 Torr)	
Temp. control accuracy	±1.0°C (at 200°C)	
Max. temp. reaching time	~80 min.	~120 min.
Interior material	Stainless steel	
Exterior material	Cold rolled steel plate with baked-on melamine resin finish	
Door	Single swing door	
Heat insulating material	Glass wool	
Heater	Mica heater, 2.25 kW	Mica heater, 3.15 kW
Vacuum gauge	Bourdon tube type, 0 ~ -0.1 MPa (Gauge pressure)	
Observation window	Tempered glass and polycarbonate resin plate	
Temp. control method	PID control by microprocessor	
Temp. setting method	Digital setting with ▲/▼ keys	
Temp. display method	Green LED digital display	
Timer	1 min. to 99 Hrs. 59 min. and 100 Hrs. to 999 Hrs. and 50 min.	
Min. division	1 min. or 10 mins.	
Operation function	Fixed temperature operation, Quick auto stop, Auto-start operation, Auto-stop operation, Program operation (16 segments)	
Additional functions	Calendar timer (max. 24 Hrs.), Integration time (max. 49999 Hrs.), Time display	
Heater circuit control	Triac zero-cross control	
Temp. sensor	K-thermocouple (double sensor)	
Safety device	Self diagnostic functions (Sensor, Heater, Triac, Automatic overheating prevention), Independent overheating prevention, Key lock function, Electric leakage breaker	
Internal dimensions (WxDxH)	450×450×450 mm	600×600×600 mm
External dimensions (WxDxH)	670×669×1500 mm	820×819×1650 mm
Internal capacity	91L	216L
Shelf Support Qty. / Pitch	4 steps / 105mm	4 steps / 140mm
Exhaust port / Purge port	NW25 flange / Rc 1/4 (18mm O.D.)	
Power source	220V, single phase, 11A no plug, round terminal	220V, single phase, 15A no plug, round terminal
Weight	~190kg	~290kg
Shelf	2 perforated stainless steel shelves	

Method

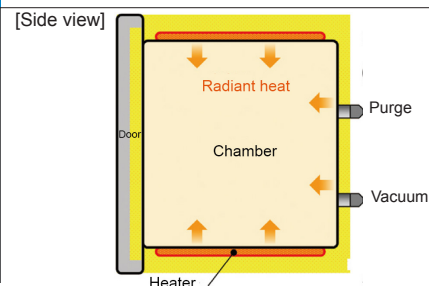

Control Panel

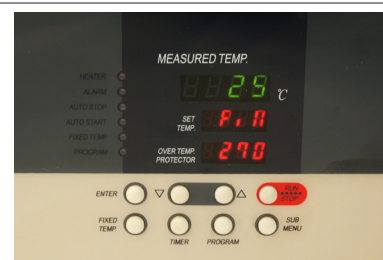

Pressure Falling Curve

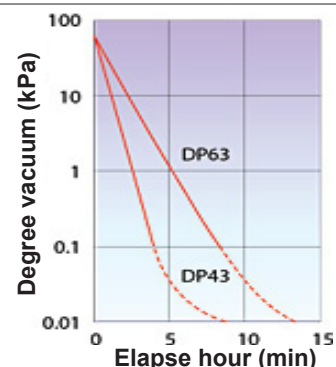

Optional Items

Description	Product Code
DP43C shelf	212192
DP63C shelf	212193
Temperature output terminal	281609
*N ₂ Gas Introduction Device 30L/min. (Factory Installed)	281151
*Vacuum Pump Switch (For DP43C/63C) (Factory Installed)	281152
Oil-sealed rotary vacuum pump	
GLD201B with rubber hose kit 115V	GLD201B115DPRKIT
GLD201B with SUS hose kit 115V	GLD201B115DPSKIT
GLD201B with rubber hose kit 220V	GLD201B220DPRKIT
GLD201B with SUS hose kit 220V	GLD201B220DPSKIT

* Please specify when ordering main unit.

Dimensions (Unit:mm)

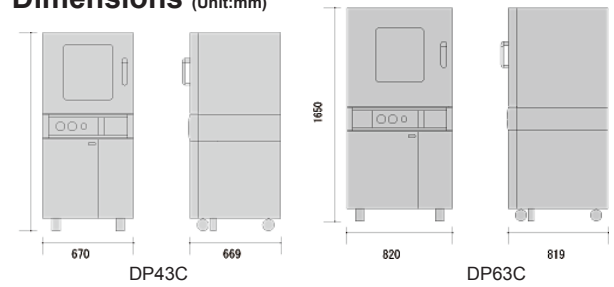

Sample Installation with CA801

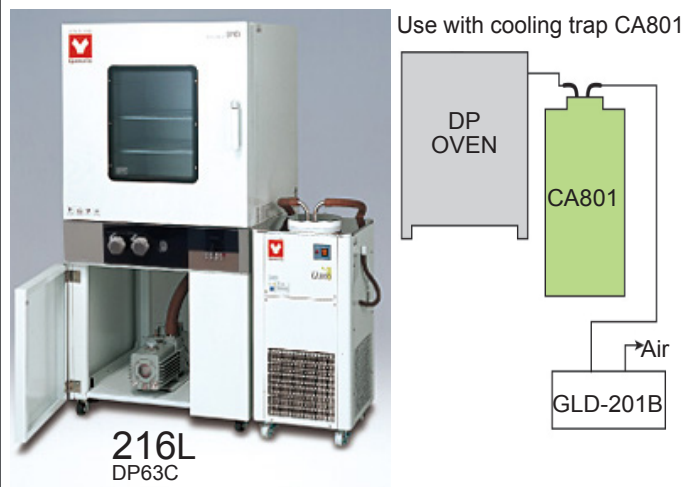

DP OVEN NW25 Flange

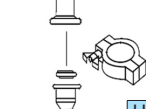

ULV-DP2333RKIT	
Hose Port Type Suction Pipe (OD:18mm x M20)	
50mm Square Adaptor for suction port	
Rubber Hose ID 16mm x 5'/1500mm	
Hose Clamp for ID: 7/16" - 11mm hose	

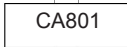

ULV-DPCARKIT	
NW25 18mm Hose Nozzle	
NW25 Centering O-ring	
NW25 Hinged Clamp	
Rubber Hose ID 16mm x 5'/1500mm	
Hose Clamp for ID: 7/16" - 11mm hose	

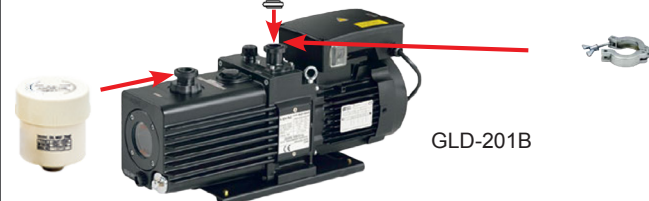

Rubber Hose or Stainless Steel Hose Connection for Vacuum Pump

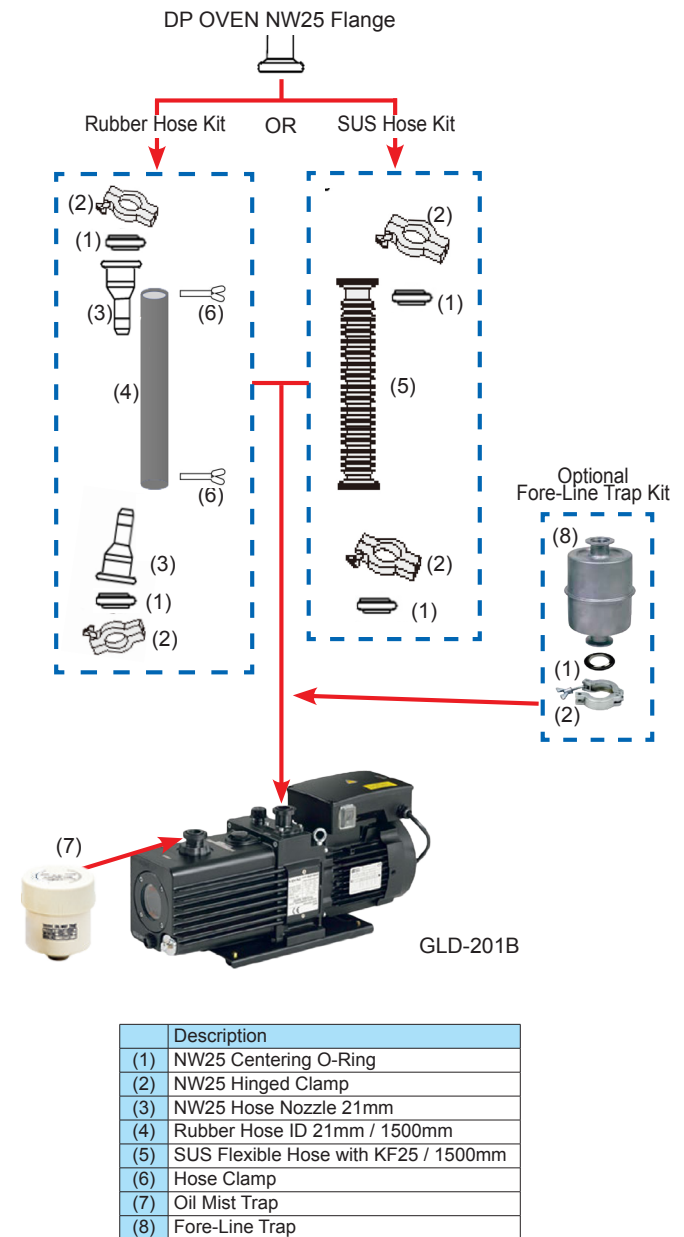

Attention

- Never use in flammable or explosive gas atmosphere
- Never use explosive or flammable material
- Caution: High temperature components